

U_w CALCULATION

1)	AREA of GLASS	5,24	m ²
2)	GLASS U _g Value	1,10	W/m ² .K
3)	AREA of PVC PR.	1,02	m ²
4)	PVC PR. U _f Value	1,57	W/m ² .K
5)	CIRCUMFERENCE of GLASS	13,14	m
	PSI of GLASS	0,04	W/m.K

(PSI FIX)

WINDOW U_w VALUE

1,26 W/m².K

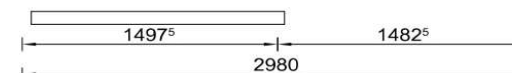
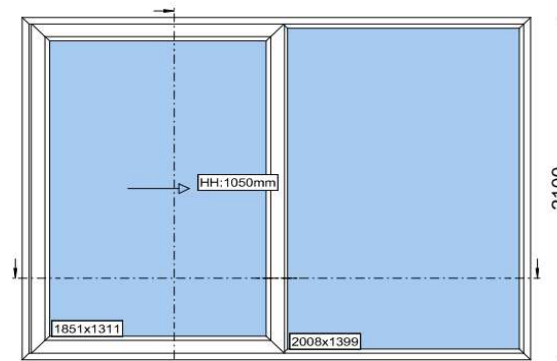

Glass Combination

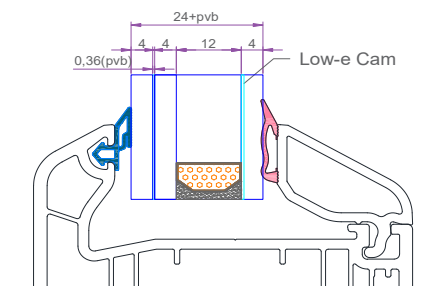

U_g = 1,1 W/m².K

U_f Calculation

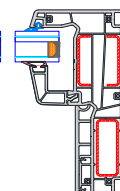
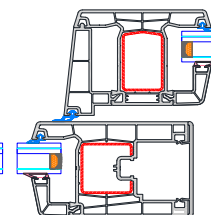
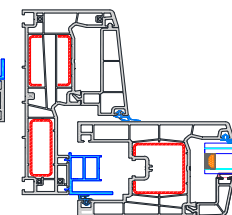
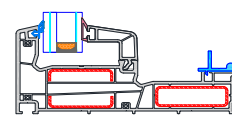
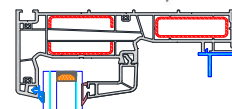
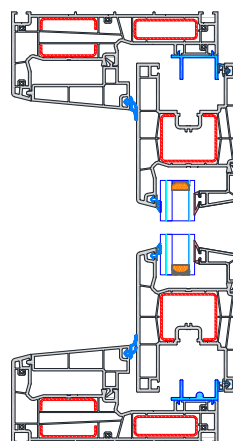
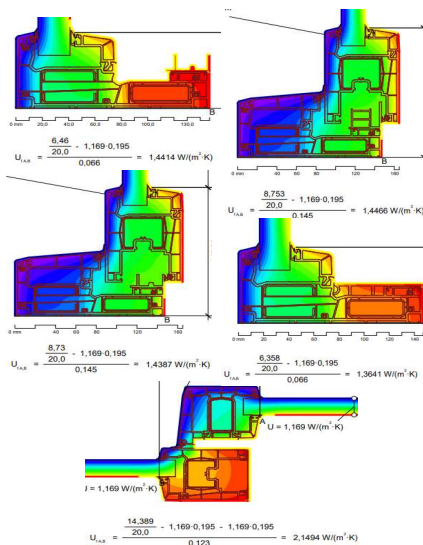

Thermische berekeningen werden uitgevoerd volgens EN ISO 10077-1:2006 & EN ISO 10077-2:2003.

Les valeurs thermiques ont été déterminées conformément aux normes EN ISO 10077-1:2006 & EN ISO 10077-2:2003.

Thermal calculations were performed in accordance with EN ISO 10077-1:2006 & EN ISO 10077-2:2003.

****Note****

**These results are theoretical values obtained in a computer environment using the flixo program. They may differ from tests performed under real-world conditions.

**These calculations have been prepared for informational purposes only. Ramendepot accepts no responsibility for the results provided.